

PRODUCT COMPONENTS

Refer to [Figure 1](#).

PRODUCT SELECTION

1. Determine the inside diameter of the outer duct and the outside diameter of the cable or inner duct. Select the correct plug from [Table 1 on Page 2](#).

INSTALLATION INSTRUCTIONS

1. Remove the top sealing collar and separate into two pieces as shown in [Figure 2](#).
2. Some fiber optic simplex duct plugs come with integral bushing sleeves which are designed to be field-split for sealing around in-place cables when needed. Use scissors or snips to split the sleeves. Do not allow the splits in the bushings to overlap with the split in the main gasket assembly ([Figure 3](#)).
3. Split the gasket assembly and place it around the bushings and the cable. Reassemble split collar around cable and thread onto gasket assembly ([Figure 4](#)).
4. Slide assembled duct plug along cable into duct to be sealed ([Figure 5](#)). Tighten by hand while holding in place. Complete sealing by tightening with a strap wrench.

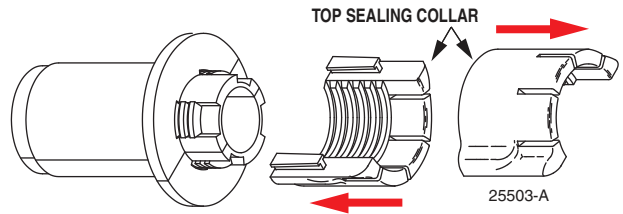

Figure 2

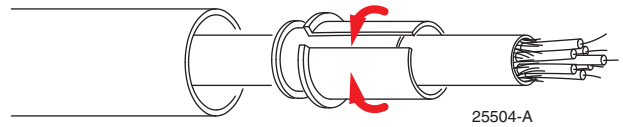

Figure 3

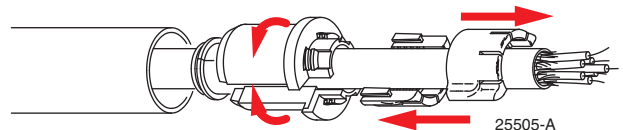

Figure 4

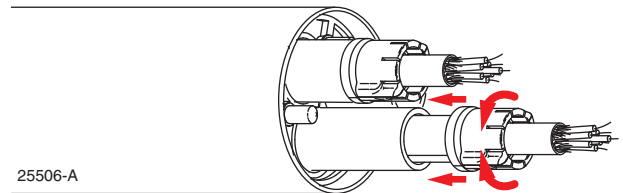

Figure 5

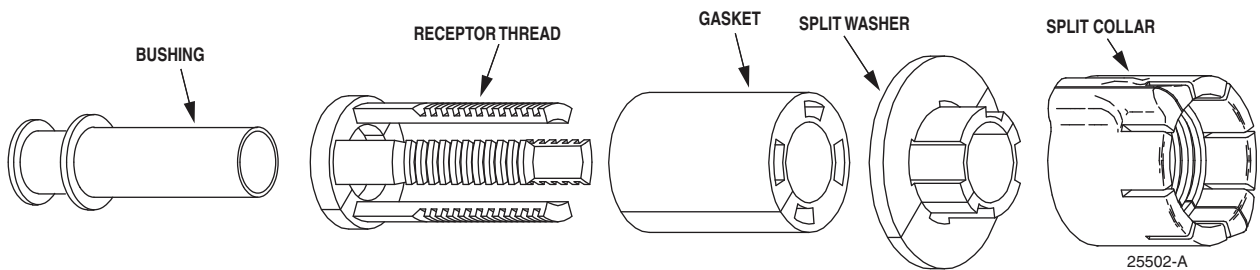

Figure 1

ORDERING INFORMATION

Refer to [Table 1](#). Dimensions are shown in inches and millimeters.

Table 1. Sizes and Specifications

PART NUMBER	PRODUCT DESCRIPTOR*	SIZE	DUCT ID RANGE		CABLE OR DUCT OD RANGE	
			(INCHES)	(MM)	(INCHES)	
136808	JM-SIM-06S038SB	0.600	0.63-0.71	16.0-18.0	0.27-0.39	6.9-9.9
E62262	JM-SIM-06035SB	0.700	0.74-0.80	18.8-20.3	0.27-0.35	6.9-8.9
A25290	JM-SIM-07S020SB	0.750	0.78-0.86	19.8-21.8	0.08-0.20	2.0-5.1
F11916	JM-SIM-07S035SB	0.750	0.78-0.86	19.8-21.8	0.20-0.35	5.1-8.9
D30443	JM-SIM-07S040SB	0.750	0.78-0.86	19.8-21.8	0.33-0.39	8.4-9.9
D43096	JM-SIM-07S050SB-043H	0.750	0.78-0.86	19.8-21.8	0.31-0.50	7.9-12.7
C00384	JM-SIM07S057SB	0.750	0.78-0.82	19.8-20.8	0.35-0.57	8.9-14.5
356346	JM-SIM-09S050SB	0.900	0.92-1.02	23.4-25.9	0.35-0.50	8.9-12.7
E43152	JM-SIM-09S050SB-043H	0.900	0.92-1.02	23.4-25.9	0.35-0.50	8.9-12.7
E64616	JM-SIM-10S020SB	1.000	1.00-1.14	25.4-29.0	0.08-0.20	2.0-5.1
A87868	JM-SIM-10S035SB	1.000	1.00-1.14	25.4-29.0	0.20-0.35	5.1-8.9
O32536	JM-SIM-10S057SB	1.000	1.00-1.14	25.4-29.0	0.35-0.57	8.9-14.5
150356	JM-SIM-10S070SB	1.000	1.00-1.14	25.4-29.0	0.51-0.71	13.0-18.0
E23652	JM-SIM-11S020SB	1.100	1.12-1.26	28.4-32.0	0.08-0.20	2.0-5.1
C45061	JM-SIM-11S035SB	1.100	1.12-1.26	28.4-32.0	0.20-0.35	5.1-8.9
120176	JM-SIM-11S057SB	1.100	1.12-1.26	28.4-32.0	0.35-0.57	8.9-14.5
289982	JM-SIM-11S070SB	1.100	1.12-1.26	28.4-32.0	0.51-0.71	13.0-18.0
509746	JM-SIM-11S078SB	1.100	1.12-1.26	28.4-32.0	0.57-0.78	14.5-19.8
151270	JM-SIM-12S043S	1.250	1.22-1.36	31.0-34.5	0.35-0.43	8.9-10.9
C51983	JM-SIM-12S043SB-024H	1.250	1.22-1.36	31.0-34.5	0.24-0.43	6.1-10.9
960202	JM-SIM-12S057SB	1.250	1.22-1.36	31.0-34.5	0.35-0.57	8.9-14.5
33111D	JM-SIM-12S057S-FD1	1.250	1.22-1.36	31.0-34.5	FlatDrop	179x.325x1
101316	JM-SIM-12S057SB-043H	1.250	1.22-1.36	31.0-34.5	0.35-0.57	8.9-14.5
YD8520	JM-SIM-12S065S-FD2	1.250	1.22-1.36	31.0-34.5	FlatDrop	179x.325x2
424922	JM-SIM-12S070SB	1.250	1.22-1.36	31.0-34.5	0.51-0.71	13.0-18.0

Table 1. Sizes and Specifications, continued

PART NUMBER	PRODUCT DESCRIPTOR*	SIZE	DUCT ID RANGE		CABLE OR DUCT OD RANGE	
			(INCHES)	(MM)	(INCHES)	
247320	JM-SIM-12S070SB-057H	1.250	1.22-1.36	31.0-34.5	0.51-0.71	13.0-18.0
610036	JM-SIM-12S090SB	1.250	1.24-1.34	31.5-34.0	0.71-0.90	18.0-22.9
3S4902	JM-SIM-12S090S-FD3	1.250	1.24-1.34	31.5-34.0	FlatDrop	179x.325x3
360030	JM-SIM-12S090SB-078H	1.250	1.24-1.34	31.5-34.0	0.71-0.90	18.0-22.9
D34944	JM-SIM-13S043SB	1.375	1.37-1.50	34.8-38.1	0.12-0.43	3.0-10.9
F37918	JM-SIM-13S043SB-024H	1.375	1.37-1.50	34.8-38.1	0.24-0.43	6.1-10.9
240386	JM-SIM-13S057SB	1.375	1.37-1.50	34.8-38.1	0.35-0.57	8.9-14.5
201624	JM-SIM-13S070SB	1.375	1.37-1.50	34.8-38.1	0.51-0.71	13.0-18.0
539922	JM-SIM-13S097SB	1.375	1.33-1.46	33.8-37.1	0.71-0.97	18.0-24.6
D21504	JM-SIM-15S020SB	1.500	1.46-1.65	37.1-41.9	0.08-0.20	2.0-5.1
A81771	JM-SIM-15S035SB	1.500	1.46-1.65	37.1-41.9	0.08-0.35	2.0-8.9
E55265	JM-SIM-15S043SB-024H	1.500	1.46-1.65	37.1-41.9	0.24-0.43	6.1-10.9
554508	JM-SIM-15S057SB	1.500	1.46-1.65	37.1-41.9	0.35-0.57	8.9-14.5
468786	JM-SIM-15S057SB-043H	1.500	1.46-1.65	37.1-41.9	0.35-0.57	8.9-14.5
751892	JM-SIM-15S070SB	1.500	1.46-1.65	37.1-41.9	0.51-0.71	13.0-18.0
106654	JM-SIM-15S070SB-057H	1.500	1.46-1.65	37.1-41.9	0.51-0.71	13.0-18.0
588288	JM-SIM-15S090SB	1.500	1.55-1.65	39.4-41.9	0.71-0.90	18.0-22.9
D15639	JM-SIM-15S090SB-078H	1.500	1.55-1.65	39.4-41.9	0.71-0.90	18.0-22.9
428444	JM-SIM-15S110SB	1.500	1.55-1.65	39.4-41.9	0.90-1.10	22.9-27.9
582536	JM-SIM-15S070AB	1.500	1.58-1.73	40.1-43.9	0.51-0.71	13.0-18.0
331954	JM-SIM-15S110AB	1.500	1.58-1.73	40.1-43.9	0.90-1.10	22.9-27.9
D44866	JM-SIM-20S020SB	2.000	1.82-1.97	46.2-50.0	0.08-0.20	2.0-5.1
D82343	JM-SIM-20S035SB	2.000	1.82-1.97	46.2-50.0	0.08-0.35	2.0-8.9
C10624	JM-SIM-20S043SB-024H	2.000	1.82-1.97	46.2-50.0	0.24-0.43	6.1-10.9
819946	JM-SIM-20S057SB	2.000	1.82-1.97	46.2-50.0	0.35-0.57	8.9-14.5
520796	JM-SIM-20S070SB	2.000	1.82-1.97	46.2-50.0	0.51-0.71	13.0-18.0
855814	JM-SIM-20S090SB	2.000	1.82-1.97	46.2-50.0	0.71-0.90	18.0-22.9
986500	JM-SIM-20S110SB	2.000	1.82-1.97	46.2-50.0	0.90-1.10	22.9-27.9

Table 1. Sizes and Specifications, continued

PART NUMBER	PRODUCT DESCRIPTOR*	SIZE	DUCT ID RANGE		CABLE OR DUCT OD RANGE	
			(INCHES)	(MM)	(INCHES)	
119892	JM-SIM-21S020SB	2.100	1.98-2.18	50.3-55.4	0.08-0.20	2.0-5.1
D12262	JM-SIM-21S035SB	2.100	1.98-2.18	50.3-55.4	0.20-0.35	5.1-8.9
190356	JM-SIM-21S057SB	2.100	1.98-2.18	50.3-55.4	0.35-0.57	8.9-14.5
906724	JM-SIM-21S070SB	2.100	1.98-2.18	50.3-55.4	0.51-0.71	13.0-18.0
923872	JM-SIM-21S090SB	2.100	1.98-2.18	50.3-55.4	0.71-0.90	18.0-22.9
914472	JM-SIM-21S110SB	2.100	1.98-2.18	50.3-55.4	0.90-1.10	22.9-27.9
595426	JM-SIM-21S110AB	2.100	2.14-2.22	54.4-56.4	0.90-1.10	22.9-27.9

***Suffix Descriptor:** S = standard PVC and PE ducts (ID); A= oversize duct (ID); B = inner bushings included; #H = hold plugs included; FD# = bushing for flat fiber drop included.

TE Connectivity

8000 Purfoy Road

Fuquay-Varina NC 27526-3000

Tel.: 919-557-8900

Fax: 919-557-8948

www.tycoelectronics.com

www.us.telecomosp.com

TE (logo), TE Connectivity, XAGA, and Raychem are trademarks of Tyco Electronics Corporation.

The information given herein, including drawings, illustrations, and schematics, which are intended for illustration purposes only, is believed to be reliable. However, Tyco Electronics makes no warranties as to accuracy or completeness, and disclaims any liability in connection with use. Tyco Electronic's obligations shall only be set forth in Tyco Electronic's Standard Terms and Conditions for Sale for this product and in no case will Tyco Electronics be liable for incidental, indirect, or consequential damages arising out of the sale, resale, use, or misuse of the product. Users of Tyco Electronics products should make their own evaluation to determine the suitability of each such product for the specific application.

Fuquay document number: F441